

申請可作為學校用途的樓宇安全證明書時 必須提供的資料

向消防處及屋宇署/房屋局常任秘書長辦公室獨立審查組遞交已填妥的申請書之前，申請人必須檢視下列事項是否已經辦妥 –

1. 有否將申請書上要求提供的所須資料全部填妥。
2. 有否隨每份申請書夾附足夠數目的圖則。
3. 每份圖則上是否有下列資料：
 - a. 勾劃擬用作校舍的註冊範圍；
 - b. 註明校名、校址、申請日期、申請人的姓名及簽署；
 - c. 指出各課室、走廊、門口、走火通道、防火門、出口路線/出口門及房產內其他部份的用途(例如：洗手間、辦公室等)的位置及其尺寸(以毫米為單位，而圖則比例通常須為 1:50 或 1:100)；
 - d. 列明各房間的用途及課室編號；
 - e. 顯示每個課室最高可容納的人數(老師和學生的數目)及將要容納的學校教職員總數；
 - f. 列明任何擬用作間隔牆和出口門的建造物料(如有)；
 - g. 指示任何改建的工程(如有)；
 - h. 校舍內提供兒童睡覺的地方(如有)；及
 - i. 校舍內現有消防裝置及設備的描述。

SAMPLE

SCHOOL NAME:
 SCHOOL ADDRESS:
 CORRESPONDENCE ADDRESS:
 CONTACT PERSON & NUMBER:

APPLICANT NAME:
 APPLICANT'S SIGNATURE:
 APPLICATION DATE:
 DRAWING NUMBER:

PROPOSED SCHOOL LAYOUT PLAN (SCALE 1 : 100 @ A3 PAPER)

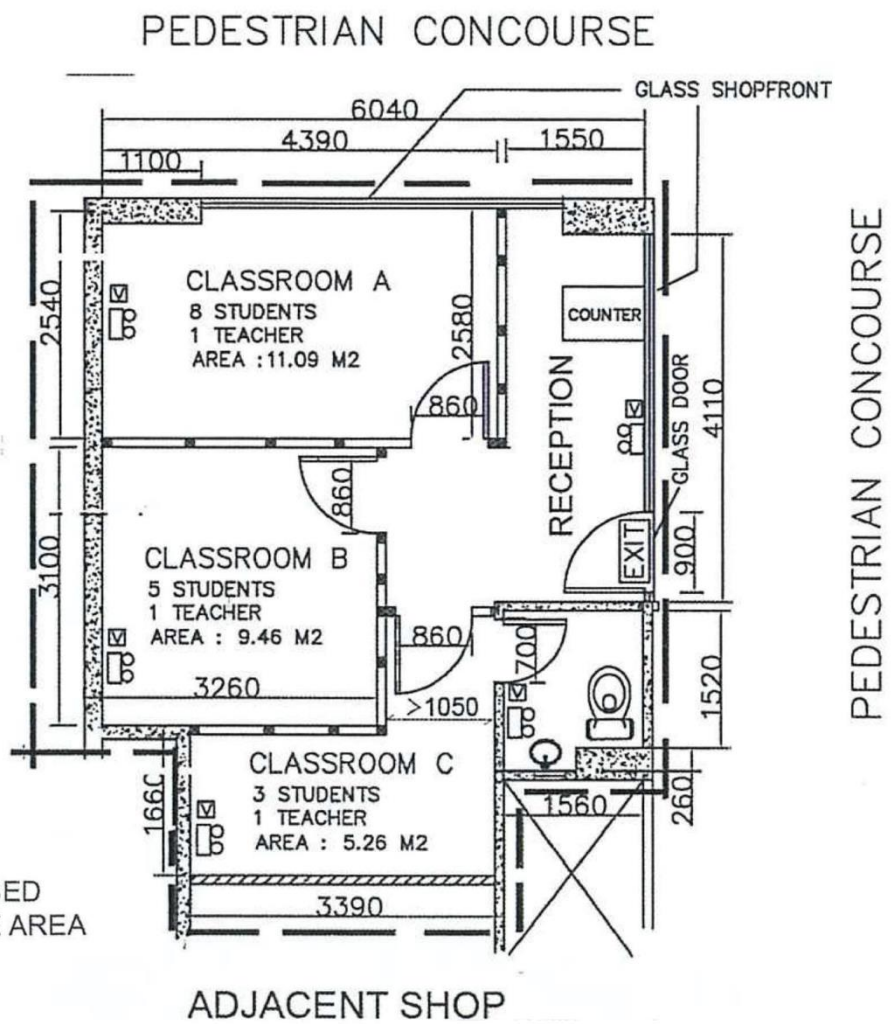

--- PROPOSED
 --- LICENSE AREA

ADJACENT SHOP

REMARKS :

- EXISTING WALL PARTITION / COLUMN AS PER APPROVED BUILDING PLAN
- EXISTING SOLID CONCRETE BLOCK WALL
- NEW LIGHT WEIGHT GYPSUM BOARD WALL PARTITION (ABOUT 80MM TH)
- TIMBER HOLLOW CORE DOOR OF WIDTH 860MM WITH VISION PANEL UNLESS OTHERWISE STATED
- NEW EMERGENCY LIGHTS INSTALLED AT H/L WITH RECHARGABLE BATTERY
- NEW CEILING-TYPE VISUAL FIRE ALARM
- NEW EXIT SIGN AT H/L WITH RECHARGABLE BATTERY

	NO. OF STUDENTS	NO. OF TEACHERS	
CLASSROOM A (11.09 M2)	8 NOS.	1 NO.	PROPOSED STUDENT NOS. = 16 PROPOSED TEACHER NOS. = 3 TOTAL POPULATION = 19 PEOPLE
CLASSROOM B (9.46 M2)	5 NOS.	1 NO.	
CLASSROOM C (5.26 M2)	3 NOS.	1 NO.	
			NO EXTRA POPULATION SHALL BE GENERATED AT RECEPTION